

Drain: INTRACOASTAL AT GEIST DRAIN **Drain #:** 334
Improvement/Arm: INTRA COASTAL AT GEIST - SECTION 2
Operator: JDH **Date:** 3-23-04
Drain Classification: Urban/Rural **Year Installed:** 2002

GIS Drain Input Checklist

- Pull Source Documents for Scanning JJA 3-23
- Digitize & Attribute Tile Drains N/A
- Digitize & Attribute Storm Drains JJA 3-23
- Digitize & Attribute SSD JJA 3-23
- Digitize & Attribute Open Ditch N/A
- Stamp Plans JJA 3-23
- Sum drain lengths & Validate JJA 3-24
- Enter Improvements into Posse JJA 3-24
- Enter Drain Age into Posse prof 3-30
- Sum drain length for Watershed in Posse prof 3-30
- Check Database entries for errors JJA 3-24



SURVEYOR'S OFFICE

Hamilton County

Kenton C. Ward, Surveyor

Phone (317) 776-8495

Fax (317) 776-9628

Suite 188

One Hamilton County Square

Noblesville, Indiana 46060-2230

October 14, 2002

To: Hamilton County Drainage Board

Re: The Intracoastal at Geist Drain, Section 1 Arm

Attached is a petition, non-enforcement request, plans, calculations, quantity summary and assessment roll for the Section 1 Arm, The Intracoastal at Geist Drain. I have reviewed the submittals and petition and have found each to be in property form.

I have made a personal inspection of the land described in the petition. Upon doing so, I believe that the drain is practicable; will improve the public health; benefit a public highway and be of public utility; and that the cost, damages and expenses of the proposed drain will probably be less than the benefits accruing to the owners of land likely to be benefited. The drain will consist of the following:

6" SSD	4,713 ft	15" RCP	176 ft	21" RCP	616 ft
12" RCP	1,123 ft	18" RCP	787 ft	24" RCP	120 ft
				48" RCP	880 ft

The total length of the drain will be 8,415 feet.

The subsurface drains (SSD) to be part of the regulated drain are those located under the curbs. Only the main SSD lines which are located within the right-of-way are to be maintained as regulated drain. Laterals for individual lots will not be considered part of the regulated drain.

I have reviewed the plans and believe the drain will benefit each lot equally. Therefore, I recommend each lot be assessed equally. I also believe that no damages will result to landowners by the construction of this drain. I recommend a maintenance assessment of \$5.00 per acre, \$65.00 per lot, \$10.00 per acre for roadways, with a \$65.00 minimum per tract. With this assessment the total annual assessment for this drain/this section will be \$4,100.10.

I believe this proposed drain meets the requirements for Urban Drain Classification as set out in IC 36-9-27-67 to 69. Therefore, this drain shall be designated as an Urban Drain.

I recommend that upon approval of the above proposed drain that the Board also approve the attached non-enforcement request. This request is for the reduction of the regulated drain easement to those easement widths as shown on the secondary plat for The Intracoastal at Geist Section 1 as recorded in the office of the Hamilton County Recorder.

I recommend the Board set a hearing for this proposed drain for November 25, 2002.



Kenton C. Ward
Hamilton County Surveyor

KCW/llm

STATE OF INDIANA)
)
COUNTY OF HAMILTON)

TO: HAMILTON COUNTY DRAINAGE BOARD
 % Hamilton County Surveyor, Courthouse, Noblesville, IN 46060

In the matter of The Intracoastal
 At Geist Subdivision, Section 1 Drain
Petition.

Petitioner is the owner of all lots in the land affected by the proposed new regulated drain. The drainage will affect various lots in The Intracoastal
 At Geist, Sec. 1 a subdivision in Hamilton County, Indiana. The general route of such drainage shall be in existing easements and along public roads as shown in the plans on file in the Surveyor's Office.

Petitioner believes that the cost, damages and expenses of the proposed improvement will be less than the benefits which will result to the owners of the land likely to be benefitted thereby. Petitioner believes the proposed improvements will:

- (a) improve public health
- (b) benefit a public street
- (c) be of public utility

Petitioner agrees to pay the cost of construction of the drainage system and requests periodic maintenance assessments by the Board thereafter.

The Petitioner also agrees to the following:

1. To provide the Drainage Board a Performance Bond for the portion of the drainage system which will be made a regulated drain. The bond will be in the amount of 100% of the Engineers estimate. The bond will be in effect until construction of 100% of the system is completed and so certified by the Engineer.

2. The Petitioner shall retain an Engineer throughout the construction phase. At completion of the project the Petitioner's Engineer shall certify that the drainage system which is to be maintained as a regulated drain has been constructed as per construction plans.

3. The Petitioner agrees to request in writing to the County Surveyor any changes from the approved plan and must receive written authorization from the County Surveyor prior to implementation of the change. All changes shall be documented and given to the Surveyor to be placed in the Drain File.
4. The Petitioner shall instruct his Engineer to provide a reproducible print on a 24" x 36" mylar of the final design of the Drainage System. This shall be submitted to the County Surveyor prior to the release of the Performance Bond.
5. The Petitioner shall comply with the Erosion Control Plan as specified on the construction plans. Failure to comply with the Erosion Control Plan shall be determined by the Board as being an obstruction to the drainage system. The County Surveyor shall immediately install or repair the needed measures at Petitioner cost as per IC 36-9-27-46.

The Petitioner further requests that the Drain be classified as an Urban Drain.

Thomas L. Kutz, Land Development Manager
Printed Name



Signed Centex Homes, A Nevada General Partnership
By: Centex Real Estate Corporation, A Nevada
Corporation Its: Managing General Partner
Printed Name

RECORDED OWNER(S) OF LAND INVOLVED

DATE 6-20-02

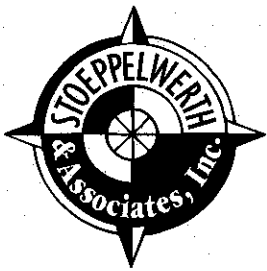

CONSULTING ENGINEERS
LAND SURVEYORS

R.M. Stoepelwerth, PE, PLS • David J. Stoepelwerth, PE, PLS • Curtis C. Huff, PLS • Dennis D. Olmstead, PLS • Jeffery W. Darling, PLS

July 17, 2002

Hamilton County Surveyor
One Hamilton County Square
Suite 188
Noblesville, Indiana 46060

Attention: Jerry Liston

Re: The Intracoastal at Geist, Section 1

Dear Mr. Liston:

Please accept the following Engineer's Estimate for The Intracoastal at Geist, Section 1.
1. The amounts are as follows:

The Intracoastal at Geist, Section 1 Engineers Estimate

Description	Quantity	Unit	Unit Price	Total
Storm Sewer				
12" RCP	1125	LF	\$15.00	\$16,875.00
15" RCP	176	LF	\$17.25	\$3,036.00
18" RCP	787	LF	\$20.25	\$15,936.75
21" RCP	616	LF	\$23.50	\$14,476.00
24" RCP	120	LF	\$24.00	\$2,880.00
48" RCP	880	LF	\$68.00	\$59,840.00
Storm Inlets	18	EA	\$1,388.00	\$24,984.00
Storm Manholes	6	EA	\$1,385.00	\$8,310.00
Yard Inlet	11	EA	\$986.00	\$10,846.00
6" SSD w/ Backfill	6135	LF	\$4.52	\$27,730.20
12" CES	1	EA	\$251.44	\$251.44
15" CES	1	EA	\$290.50	\$290.50
18" CES	2	EA	\$316.50	\$633.00
21" CES	1	EA	\$362.82	\$362.82
48" CES	1	EA	\$1,000.00	\$1,000.00
Total				\$187,451.71

FILED

JUL 18 2002

HAMILTON COUNTY SURVEYOR'S OFFICE

Hamilton County Surveyor
Jerry Liston
July 17, 2002
Page 2

Erosion Control				
Common Area Seeding	290,834	SF	\$0.05	\$14,541.70
Swale Seeding	36,160	SF	\$0.05	\$1,808.00
Swale Matting	1,808	LF	\$0.56	\$1,012.48
R/W Seeding	92,250	SF	\$0.04	\$3,690.00
Silt Fence	2,612	LF	\$1.25	\$3,265.00
Inlet Protection	18	EA	\$70.00	\$1,260.00
Total				\$25,577.18
Monuments & Markers	23	EA	\$150.00	\$3,450.00
Total				\$3,450.00

Witness my signature this 17th day of July, 2002.

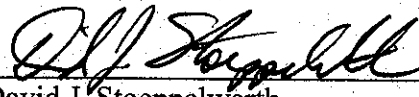

David J. Stoepelwerth
Professional Engineer
No. 19358

S/34090S1/Agency/EngEst



SUBDIVISION BOND

Bond No. 6179731

KNOW ALL MEN BY THESE PRESENTS, that we CENTEX HOMES, A NEVADA GENERAL PARTNERSHIP

as Principal, and SAFECO INSURANCE COMPANY OF AMERICA

authorized to do business in the State of INDIANA, as Surety, are held and firmly bound unto

HAMILTON COUNTY BOARD OF COMMISSIONERS

as Obligee, in the penal sum of One Hundred Eighty Seven Thousand Four Hundred Fifty One and 70/100

(\$ 187,451.70) DOLLARS, lawful money of

the United States of America, for the payment of which well and truly to be made, we bind ourselves, our heirs, executors, administrators, successors and assigns, jointly and severally, firmly by these presents.

WHEREAS, CENTEX HOMES, A NEVADA GENERAL PARTNERSHIP

has agreed to construct in THE INTRACOSTAL AT GEIST SECTION 1

the following improvements: STORM SEWER

NOW, THEREFORE, THE CONDITION OF THIS OBLIGATION IS SUCH, that if the said Principal shall construct, or have constructed, the improvements herein described and shall save the Obligee harmless from any loss, cost or damage by reason of its failure to complete said work, then this obligation shall be null and void; otherwise to remain in full force and effect.

Signed, sealed and dated this 7th day of August, 2002

CENTEX HOMES, A NEVADA GENERAL PARTNERSHIP

By: [Signature] Principal

FILED
AUG 12 2002
OFFICE OF HAMILTON COUNTY SURVEYOR

SAFECO INSURANCE COMPANY OF AMERICA

By: [Signature] BRIDGETTE S. JACKSON Attorney-in-Fact



SAFECO

POWER OF ATTORNEY

SAFECO INSURANCE COMPANY OF AMERICA
GENERAL INSURANCE COMPANY OF AMERICA
HOME OFFICE: SAFECO PLAZA
SEATTLE, WASHINGTON 98185

No. 7386

KNOW ALL BY THESE PRESENTS:

That SAFECO INSURANCE COMPANY OF AMERICA and GENERAL INSURANCE COMPANY OF AMERICA, each a Washington corporation, does each hereby appoint
.....LAWRENCE W. WALDIE; CARMEN MIMS; BRIAN M. LEBOW; DEBORAH GRIFFITH; ALLYSON DEAN; BRIDGETTE S. JACKSON; Dallas, Texas.....

its true and lawful attorney(s)-in-fact, with full authority to execute on its behalf fidelity and surety bonds or undertakings and other documents of a similar character issued in the course of its business, and to bind the respective company thereby.

IN WITNESS WHEREOF, SAFECO INSURANCE COMPANY OF AMERICA and GENERAL INSURANCE COMPANY OF AMERICA have each executed and attested these presents

this 1st day of June, 2001

R.A. Pierson

R.A. PIERSON, SECRETARY

Mike McGavick

MIKE MCGAVICK, PRESIDENT

CERTIFICATE

Extract from the By-Laws of SAFECO INSURANCE COMPANY OF AMERICA
and of GENERAL INSURANCE COMPANY OF AMERICA:

"Article V, Section 13. - FIDELITY AND SURETY BONDS ... the President, any Vice President, the Secretary, and any Assistant Vice President appointed for that purpose by the officer in charge of surety operations, shall each have authority to appoint individuals as attorneys-in-fact or under other appropriate titles with authority to execute on behalf of the company fidelity and surety bonds and other documents of similar character issued by the company in the course of its business... On any instrument making or evidencing such appointment, the signatures may be affixed by facsimile. On any instrument conferring such authority or on any bond or undertaking of the company, the seal, or a facsimile thereof, may be impressed or affixed or in any other manner reproduced; provided, however, that the seal shall not be necessary to the validity of any such instrument or undertaking."

Extract from a Resolution of the Board of Directors of SAFECO INSURANCE COMPANY OF AMERICA
and of GENERAL INSURANCE COMPANY OF AMERICA adopted July 28, 1970.

"On any certificate executed by the Secretary or an assistant secretary of the Company setting out,
(i) The provisions of Article V, Section 13 of the By-Laws, and
(ii) A copy of the power-of-attorney appointment, executed pursuant thereto, and
(iii) Certifying that said power-of-attorney appointment is in full force and effect,
the signature of the certifying officer may be by facsimile, and the seal of the Company may be a facsimile thereof."

I, R.A. Pierson, Secretary of SAFECO INSURANCE COMPANY OF AMERICA and of GENERAL INSURANCE COMPANY OF AMERICA, do hereby certify that the foregoing extracts of the By-Laws and of a Resolution of the Board of Directors of these corporations, and of a Power of Attorney issued pursuant thereto, are true and correct, and that both the By-Laws, the Resolution and the Power of Attorney are still in full force and effect.

IN WITNESS WHEREOF, I have hereunto set my hand and affixed the facsimile seal of said corporation

this 7TH day of AUGUST, 2002



R.A. Pierson

R.A. PIERSON, SECRETARY

SUBDIVISION BOND

Bond No. 6179732

KNOW ALL MEN BY THESE PRESENTS, that we CENTEX HOMES, A NEVADA GENERAL PARTNERSHIP

as Principal, and SAFECO INSURANCE COMPANY OF AMERICA

authorized to do business in the State of INDIANA, as Surety, are held and firmly bound unto

HAMILTON COUNTY BOARD OF COMMISSIONERS

as Obligee, in the penal sum of Twenty Five Thousand Five Hundred Seventy Seven and 10/100
----- (\$ 25,577.10) DOLLARS, lawful money of

the United States of America, for the payment of which well and truly to be made, we bind ourselves, our heirs, executors, administrators, successors and assigns, jointly and severally, firmly by these presents.

WHEREAS, CENTEX HOMES, A NEVADA GENERAL PARTNERSHIP

has agreed to construct in THE INTRACOSTAL AT GEIST SECTION 1

the following improvements: EROSION CONTROL

NOW, THEREFORE, THE CONDITION OF THIS OBLIGATION IS SUCH, that if the said Principal shall construct, or have constructed, the improvements herein described and shall save the Obligee harmless from any loss, cost or damage by reason of its failure to complete said work, then this obligation shall be null and void; otherwise to remain in full force and effect.

Signed, sealed and dated this 7th day of August, 2002.

CENTEX HOMES, A NEVADA GENERAL PARTNERSHIP

By: [Signature] Principal

FILED

AUG 12 2002

OFFICE OF THE SURVEYOR

SAFECO INSURANCE COMPANY OF AMERICA

By: [Signature]
BRIDGETTE S. JACKSON Attorney-in-Fact

FINDINGS AND ORDER

CONCERNING THE MAINTENANCE OF THE

Intracoastal @ Geist Drain, Section 1 Arm

On this *25th day of November 2002*, the Hamilton County Drainage Board has held a hearing on the Maintenance Report and Schedule of Assessments of the *Intracoastal @ Geist Drain, Section 1 Arm*.

Evidence has been heard. Objections were presented and considered. The Board then adopted the original/amended Schedule of Assessments. The Board now finds that the annual maintenance assessment will be less than the benefits to the landowners and issues this order declaring that this Maintenance Fund be established.

HAMILTON COUNTY DRAINAGE BOARD



President

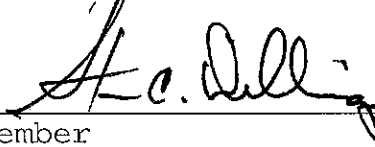

Member

Member

Attest: 

CERTIFICATE OF COMPLETION AND COMPLIANCE

To: Hamilton County Surveyor

Re: The Intracoastal at Geist

I hereby certify that:

1. I am a Registered Land Surveyor or Engineer in the State of Indiana.
2. I am familiar with the plans and specifications for the above referenced subdivision.
3. I have personally observed and supervised the completion of the drainage facilities for the above referenced subdivision.
4. The drainage facilities within the above referenced subdivision to the best of my knowledge, information and belief have been installed and completed in conformity with all plans and specifications.

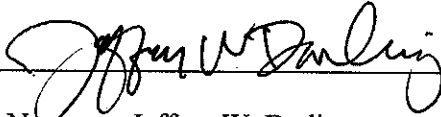
Signature:  Date: May 30, 2003

Type or Print Name: Jeffery W. Darling

Business Address: Stoepelwerth & Associates, Inc.

9940 Allisonville Road, Fishers, Indiana 46038

Telephone Number: (317) 849-5935

SEAL

INDIANA REGISTRATION NUMBER

900017



FILED

JUN 02 2003

OFFICE OF HAMILTON COUNTY SURVEYOR



SURVEYOR'S OFFICE

Hamilton County

Kenton C. Ward, Surveyor

Phone (317) 776-8495

Fax (317) 776-9628

Suite 188

One Hamilton County Square

Noblesville, Indiana 46060-2130

To: Hamilton County Drainage Board

March 31, 2004

Re: Intracoastal at Geist Drain: Sec. 1 Arm

Attached are as-builts, certificate of completion & compliance, and other information for Intracoastal at Geist Sec. 1. An inspection of the drainage facilities for this section has been made and the facilities were found to be complete and acceptable.

During construction, changes were made to the drain, which will alter the plans submitted with my report for this drain-dated . The report was approved by the Board at the hearing held November 25, 2002. (See Drainage Board Minutes Book 6, Pages 495-496)

The changes are as follows:

Structure:	T.C.:	I.E.:	Pipe:	Length:	Grade:	Original:	Difference:
115	801.3	795.49					
114	800.02	793.97	48	146	1.04	147	-1
114	800.02	793.97					
113	801.19	793.39	48	144	0.4		
113	801.19	793.39					
111A	799.76	792.72	48	119	0.56	114	5
111A	799.76	792.72					
110	799.57	792.49	48	50	0.46	53	-3
110	799.57	792.49					
107	799.3	791.8	48	134	0.51	132	2
107	799.3	791.8					
106	800.56	791.31	48	133	0.37	130	3
106	800.56	791.31					
105		786.63	48	155	3.01	160	-5
109	800.59	796.24					
108	800.02	796.1	24	31	0.45	39	-8
108	800.02	796.1					
107	799.3	795.3	24	80	1	81	-1
112	798.78	795.72					
111	798.92	795.43	12	28	1.03		
111	798.92	795.43					
111A	799.76	795.18	12	15	1.67	13	2
104	797.13	794.93					
103	798.15	794.55	12	135	0.28	136	-1

103	798.15	794.55					
102	800.38	793.95	18	203	0.3		
102	800.38	793.95					
101	800.31	793.95	18	32	0.43		
101	800.31	793.81					
100		787.14	18	146	4.56	157	-11
125	810.6	807.55					
124	808.99	805.51	12	48	4.25		
124	808.99	805.51					
123	808.99	805.16	12	56	0.63		
123	808.99	805.16					
122	803.4	799.4	12	183	3.14		
122	803.4	799.4					
121	801.92	798.42	12	112	0.88	111	1
121	801.92	798.42					
119	802.01	798.16	15	56	0.46		
120	805.93	802.88					
119	802.01	798.16	12	110	4.29		
119	802.01	798.16					
118	802.34	797.86	18	55	0.55		
118	802.34	797.86					
117	798.47	793.62	18	161	2.63		
117	798.47	793.62					
116		786.74	18	178	3.86	179	-1
139		807.34					
138	807.44	802.82	15	117	3.86	110	7
138	807.44	802.82					
133	807.49	802.69	21	33	0.39		
133	807.49	802.69					
132	808.04	801.88	21	148	0.54		
132	808.04	801.88					
131	804.93	800.93	21	92	1.03		
131	804.93	800.93					
130	801.26	796.8	21	132	3.67	131	1
130	801.26	796.08					
129	801.14	795.66	21	28	1.5		
129	801.14	795.66					
127	801	794.87	21	42	1.88		
127	801	794.87					
126		790.02	21	135	3.59	142	7
137	796.06	792.66					
136	796.06	792.46	12	28	71		
136	796.06	792.46					
135	795.39	791.79	12	60	1.12		
135	795.39	791.79					
134		784.88	12	174	3.97	175	-1
128	801.84	796.94					
127	801	794.87	12	177	1.17		

6" SSD Streets:

Coupler Drive	540
Newbury Port Drive	846
Lexi Lane	774
Fathom Lane	530
Clove Hitch	75
	x2

Total: 5560

RCP Pipe Totals:

12	1126
15	173
18	775
21	610
24	111
48	881

Total: 3676

The length of the drain due to the changes described above is now **9236 feet**.

The non-enforcement was approved by the Board at its meeting on November 25, 2002 and recorded under instrument #200300011402.

The following sureties were guaranteed by Safeco Insurance and released by the Board on its December 22, 2003 meeting.

Bond-LC No: 6179731
Insured For: Storm Sewers
Amount: \$187,415.70
Issue Date: August 7, 2002

Bond-LC No: 6179732
Insured For: Erosion Control
Amount: \$25,577.10
Issue Date: August 7, 2002

I recommend the Board approve the drain's construction as complete and acceptable.

Sincerely,



 Kenton C. Ward,
 Hamilton County Surveyor

KCW/slm

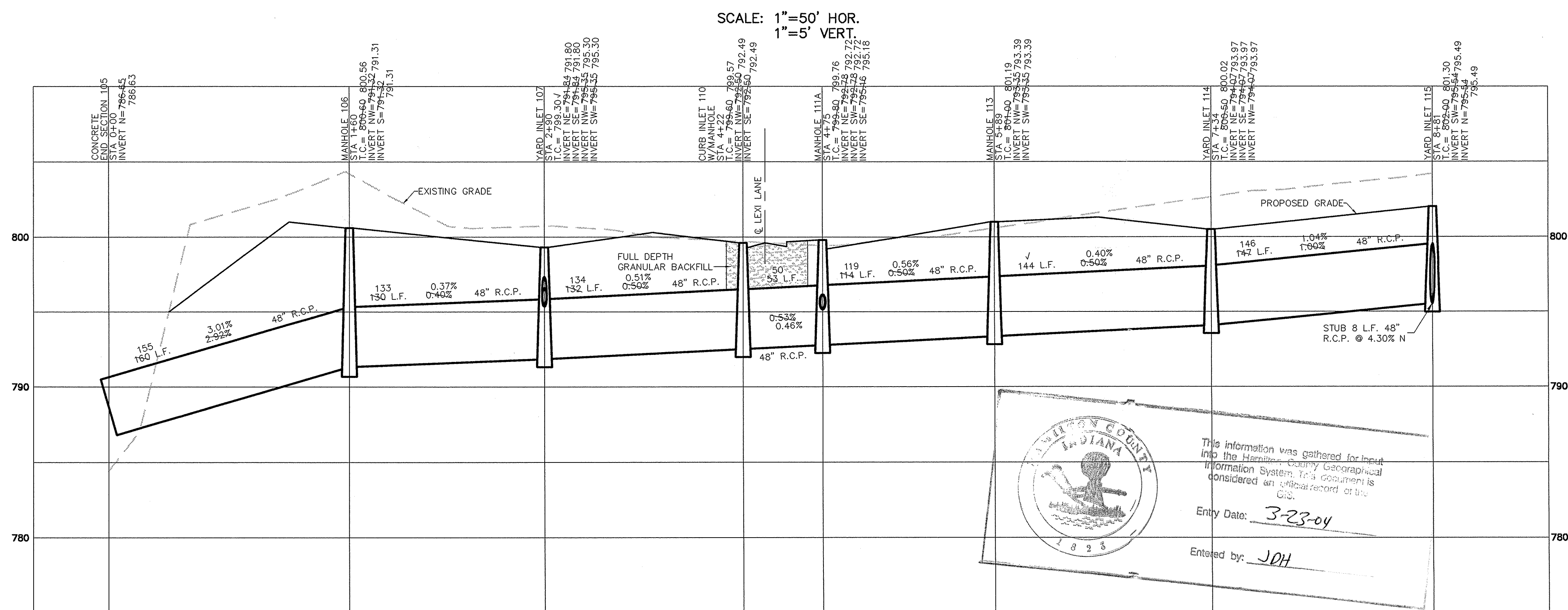
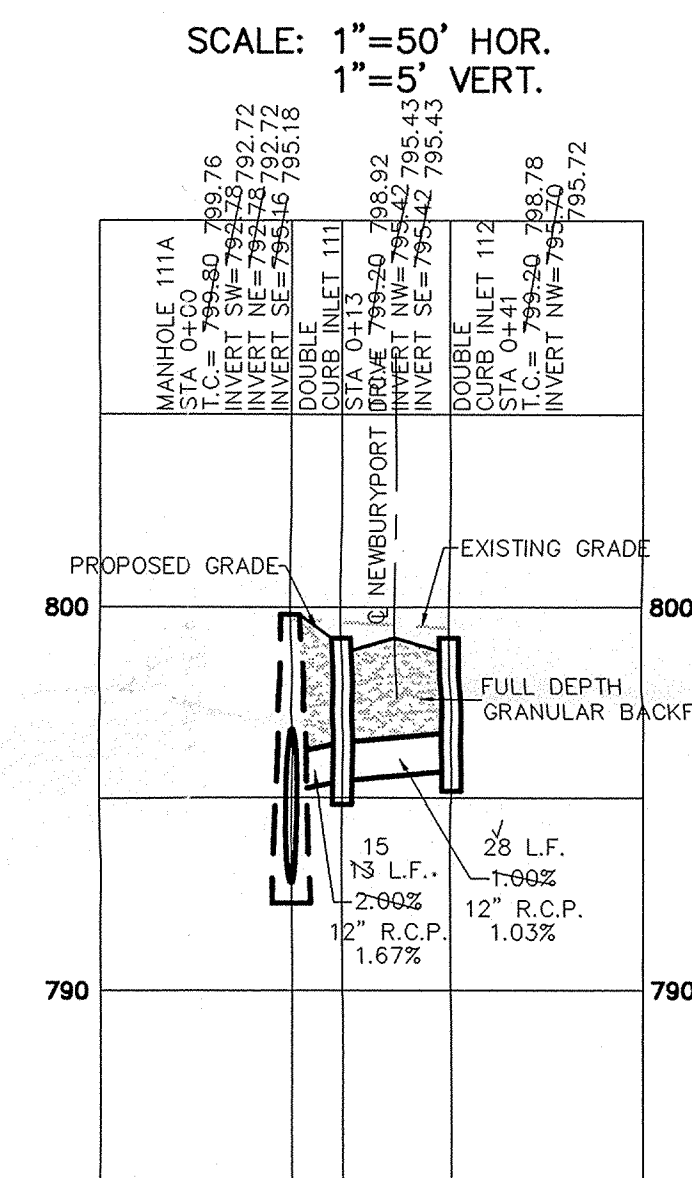
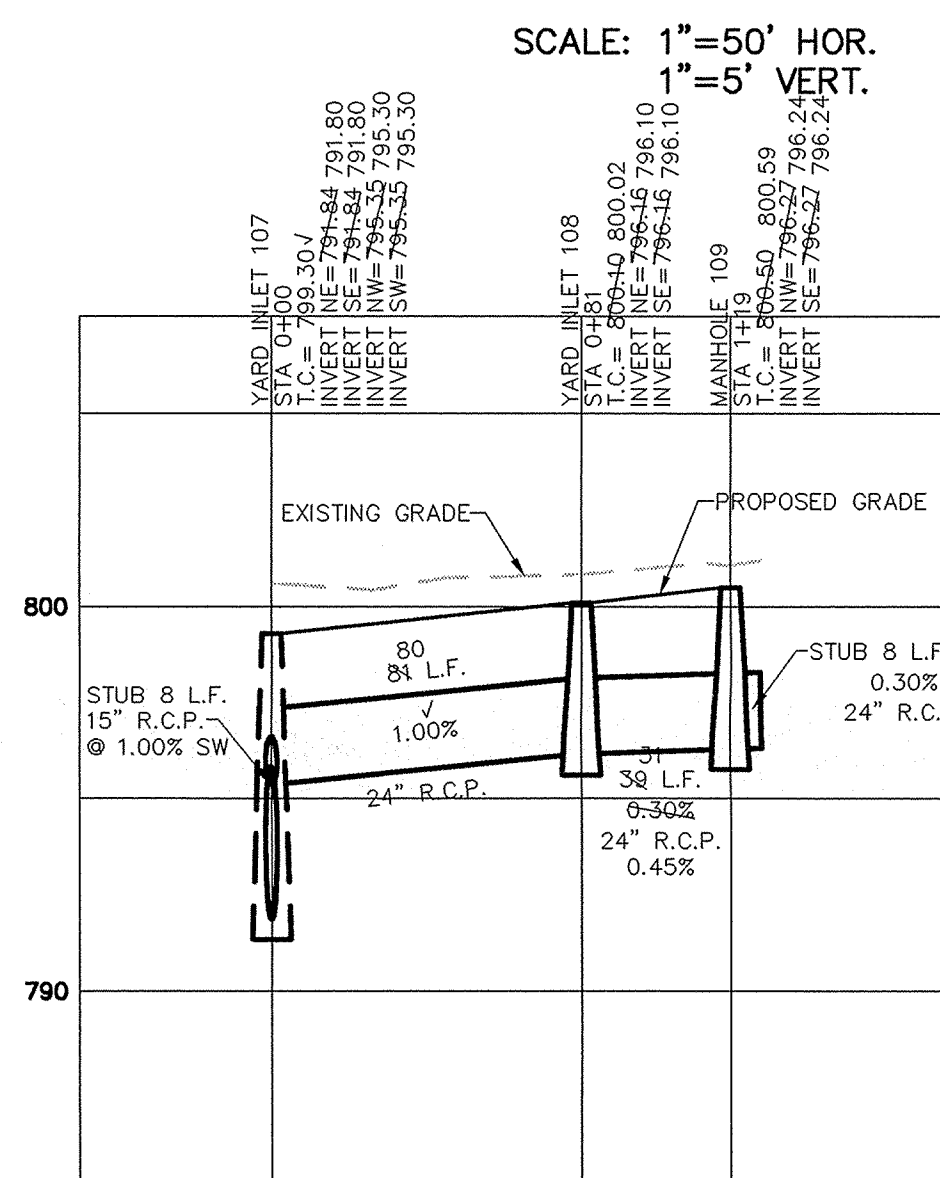
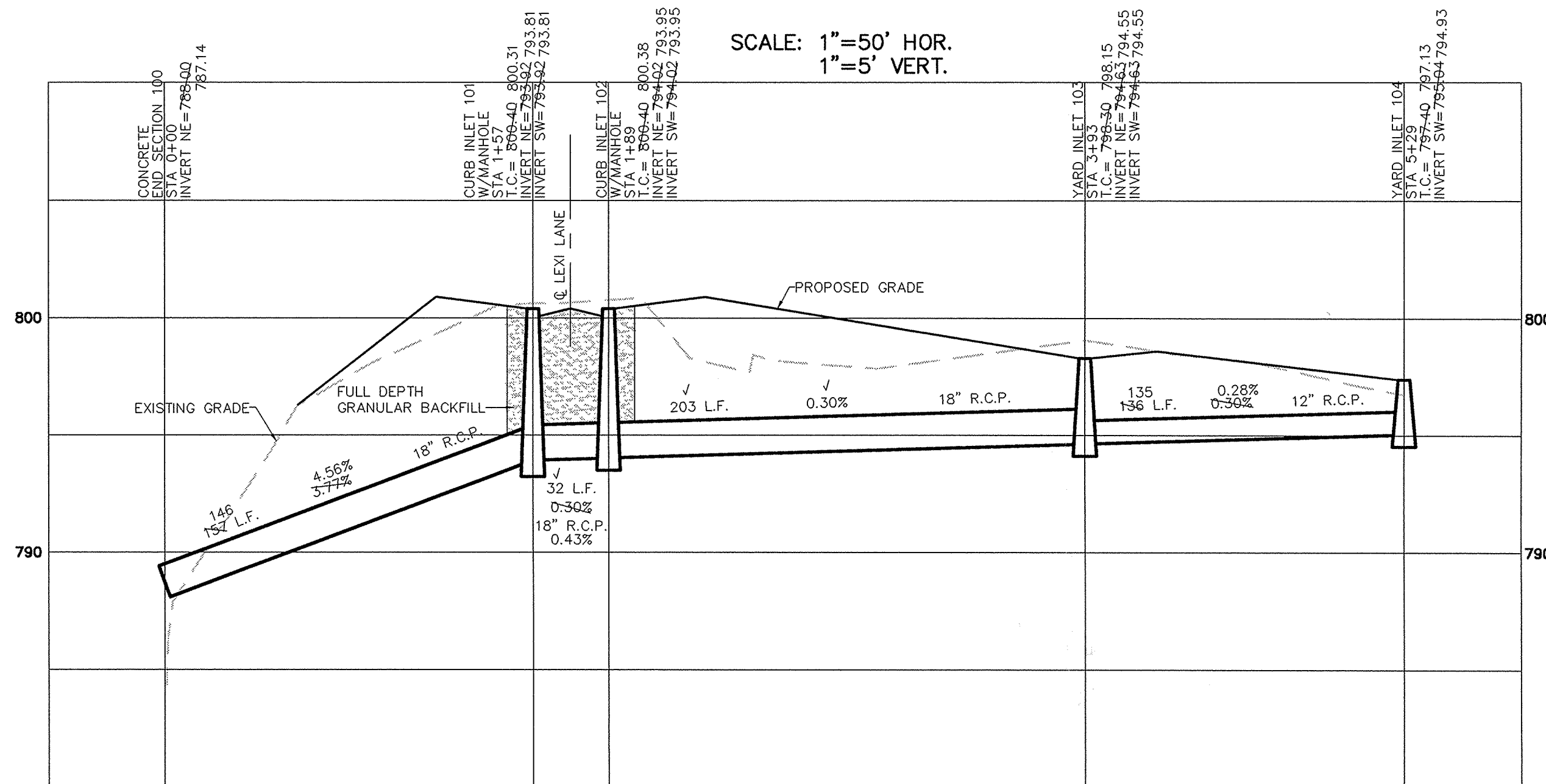
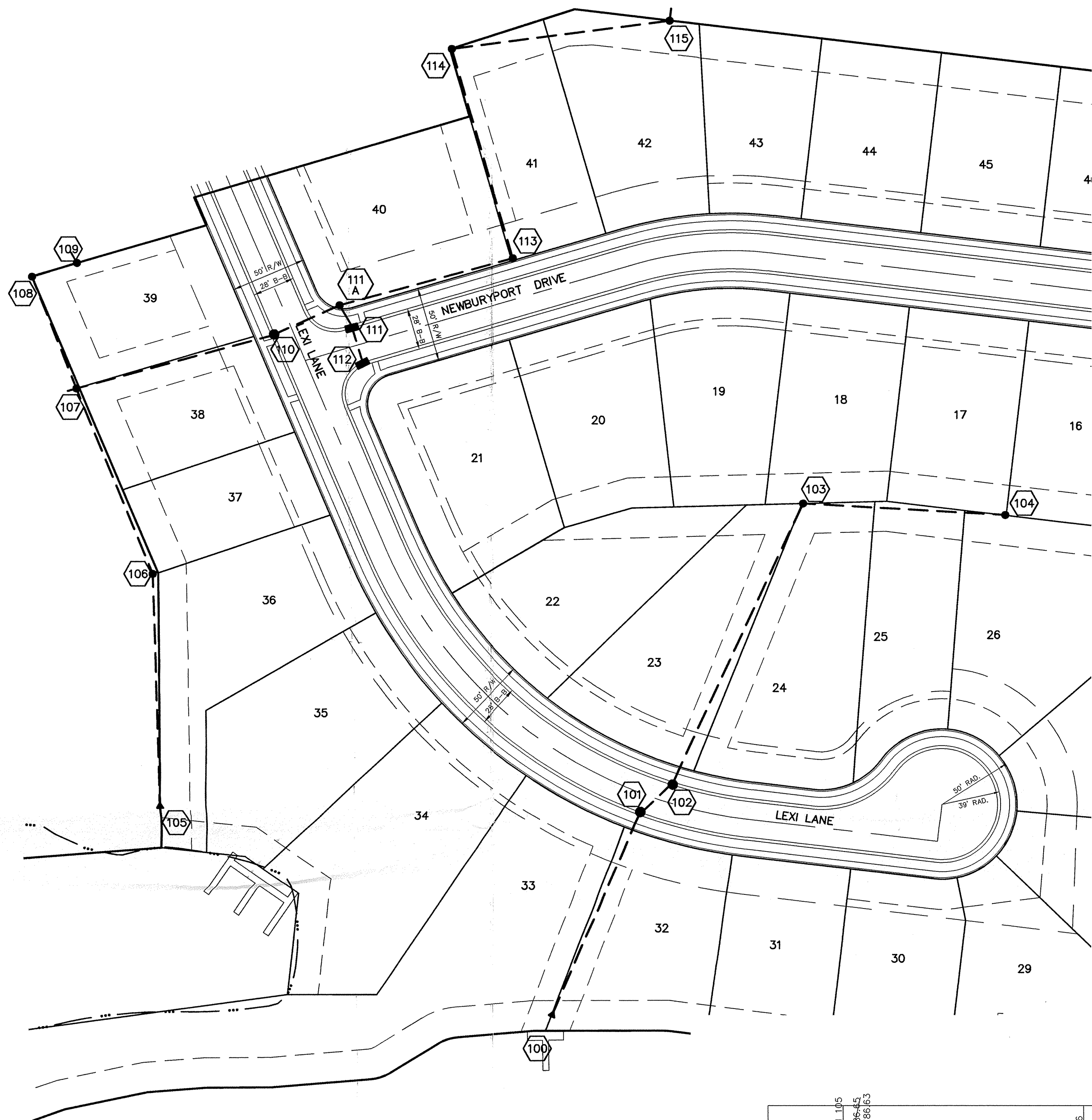

CURB INLET TABLE

PIPE SIZE	STRUCTURES LESS THAN 48" FROM T/C TO INVERT	STRUCTURES GREATER THAN 48" FROM T/C TO INVERT	ANGLE AND QUALITY OF PIPES WILL REQUIRE SPECIAL DESIGN	STEPS REQUIRED	CURB CASTING *R-3501 N	CASTING *3501 TL & TR
12" to 18"	24"x24"		DESIGN APPROVAL	No	Yes	Yes
12" to 21"	30"x30"		DESIGN APPROVAL	No	Yes	Yes
18" to 21"		MH/BOX	DESIGN APPROVAL	Yes	Yes	Yes
21" to 27"	24"x36"		DESIGN APPROVAL	No	No	Yes
12" to 24"	36"x36"		DESIGN APPROVAL	No	Yes	Yes
24" OR LARGER	DESIGN APPROVAL		DESIGN APPROVAL	No	No	Yes
		MH/BOX	DESIGN APPROVAL	Yes**	Yes	Yes

* PIPES NO LARGER THAN 18" CAN BE USED IN THE 2' SIDE OF THIS BOX.
 ** INCOMING AND OUT GOING PIPES EFFECT STEPS IN THIS STRUCTURE.

SPECIAL NOTE:
 STRUCTURES DEEPER THAN 48" FROM T/C TO INVERT WILL BE A MH OR A BOX WITH STEPS UNLESS SPECIAL DESIGN IS APPROVED.

SPECIAL NOTE:
 STRUCTURES WILL BE DESIGNED FOR MAXIMUM FLOW IN PIPES

SPECIAL NOTE:
 COUNTY MAY REQUIRE STEPS TO BE INSTALLED AFTER STRUCTURE IS SET, TO IMPROVE ACCESS.

RECORD DRAWING

Jeffery W. Darling
 Jeffery W. DARLING
 Registered Land Surveyor
 No. 900017

5/29/03
 DATE

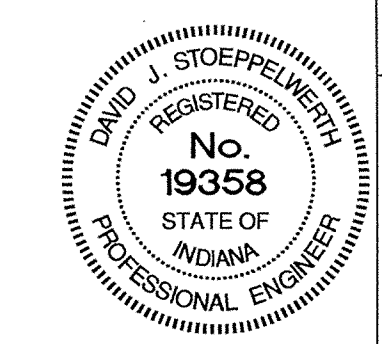

CERTIFIED: 1/24/02

DATE BY: 1/24/02

CRN: 1/24/02

DATE: 1/24/02

REVISIONS:

NO.	DATE	BY	REVISIONS
1	5/29/03	CRN	AS-BUILT
2	7/29/03	CRN	RECORD PER USE COMMENTS
3	7/29/02	CRN	RECORD PER USE COMMENTS
4	5/27/02	CRN	RECORD PER USE COMMENTS

CONSULTING ENGINEERS - LAND SURVEYORS
 (317) 849-5935 1-800-728-6917 FAX: (317) 849-5942
 INDIANAPOLIS INDIANA



STORM SEWER PLAN & PROFILE
THE INTRACOASTAL AT GEIST SECTION 1
 HAMILTON COUNTY INDIANA

SHEET NO. **28**
 OF 37 SHEETS
 JOB NO. 34090

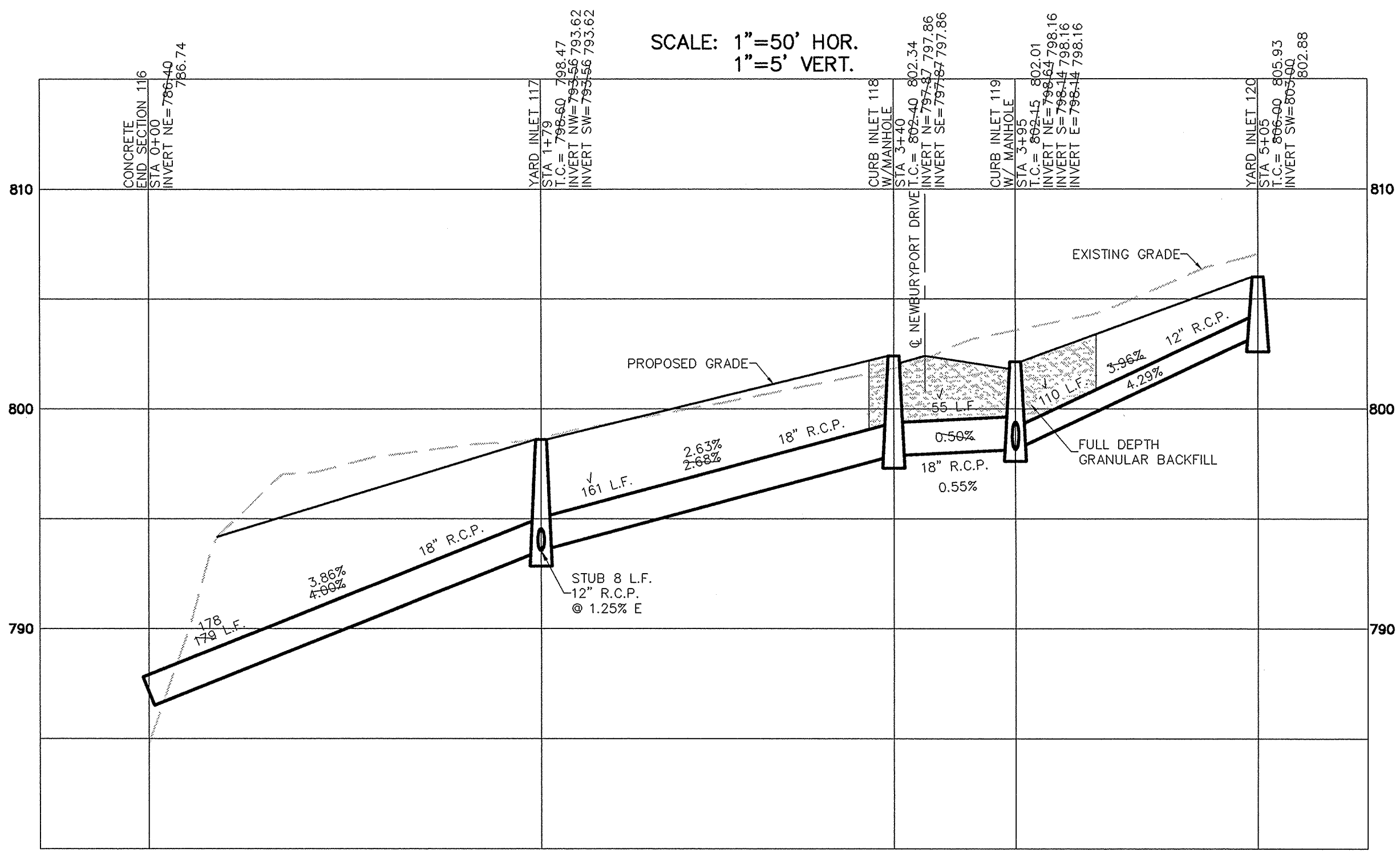
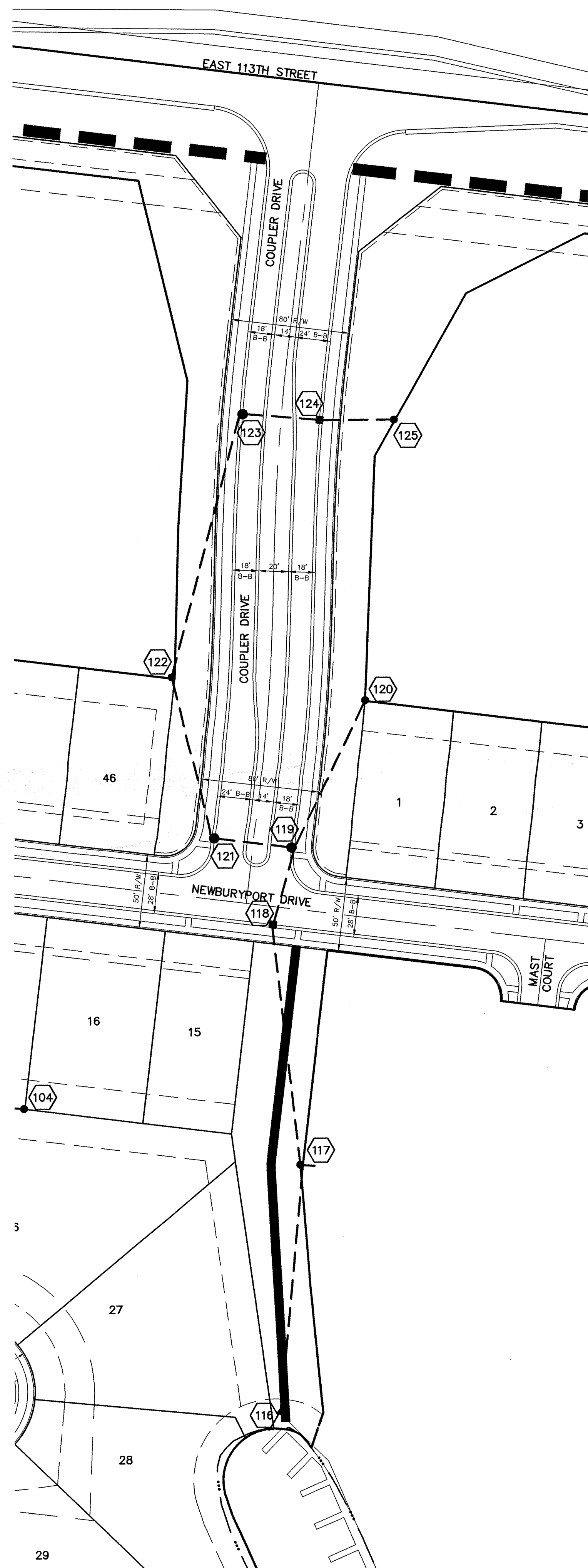

CURB INLET TABLE

PIPE SIZE	STRUCTURES LESS THAN 48" FROM T/C TO INVERT	STRUCTURES GREATER THAN 48" FROM T/C TO INVERT	ANGLE AND QUALITY OF PIPES WILL REQUIRE SPECIAL DESIGN	STEPS REQUIRED	CURB CASTING *R-3501 N	CASTING *3501 TL & TR
12" to 18"	24"x24"		DESIGN APPROVAL	No	Yes	Yes
12" to 21"	30"x30"		DESIGN APPROVAL	No	Yes	Yes
18" to 21"		MH/BOX	DESIGN APPROVAL	Yes	Yes	Yes
21" to 27"	24"x36"		DESIGN APPROVAL	No	No	Yes
12" to 24"	36"x36"		DESIGN APPROVAL	No	Yes	Yes
24" OR LARGER	DESIGN APPROVAL		DESIGN APPROVAL	No	No	Yes
24" or LARGER		MH/BOX	DESIGN APPROVAL	Yes**	Yes	Yes

* PIPES NO LARGER THAN 18" CAN BE USED IN THE 2' SIDE OF THIS BOX
 ** INCOMING AND OUT GOING PIPES EFFECT STEPS IN THIS STRUCTURE
 SPECIAL NOTE: STRUCTURES DEEPER THAN 48" FROM T/C TO INVERT WILL BE A M.H. OR A BOX WITH STEPS UNLESS SPECIAL DESIGN IS APPROVED.
 SPECIAL NOTE: STRUCTURES WILL BE DESIGNED FOR MAXIMUM FLOW IN PIPES
 SPECIAL NOTE: COUNTY MAY REQUIRE STEPS TO BE INSTALLED AFTER STRUCTURE IS SET, TO IMPROVE ACCESS.

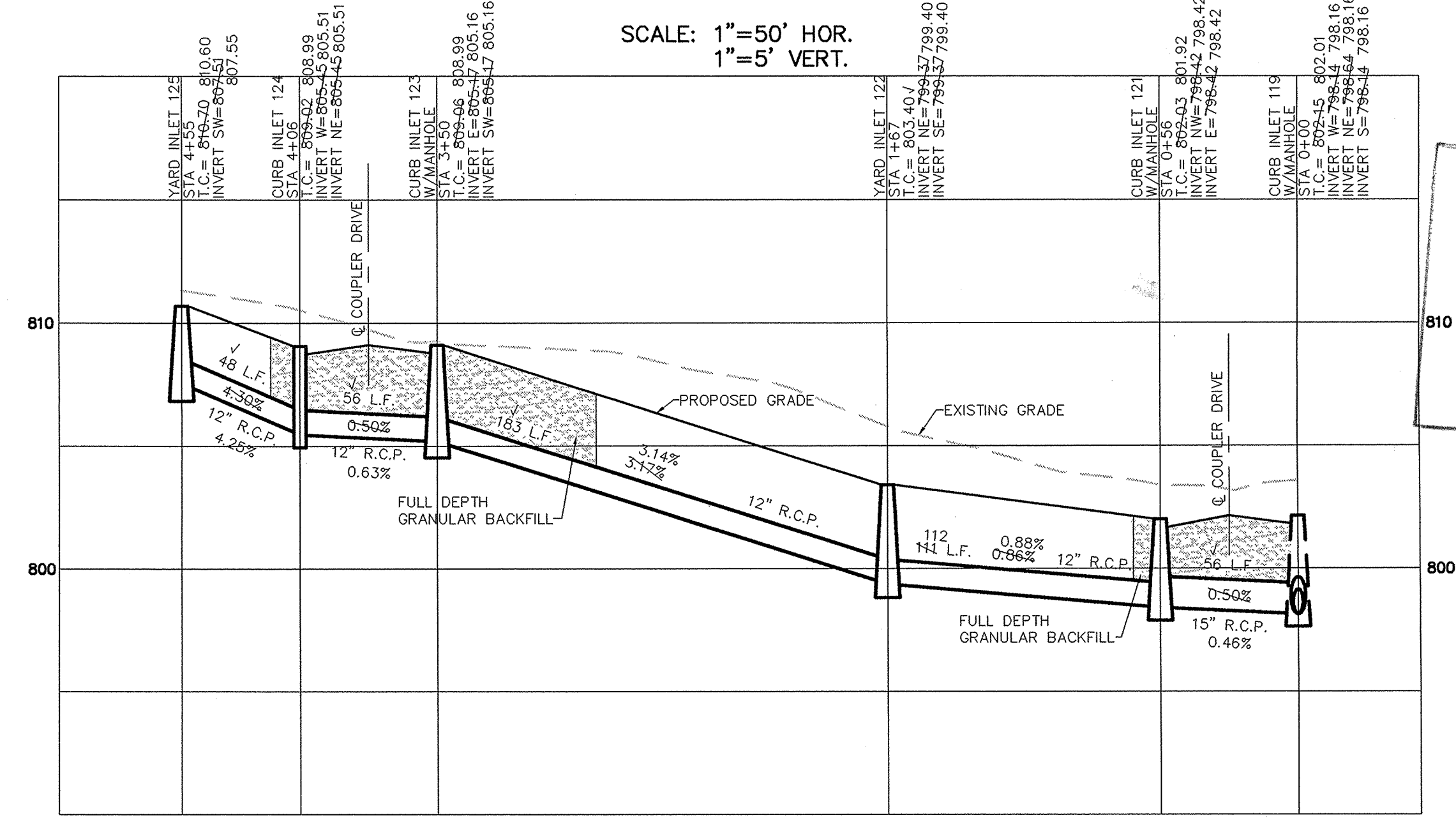

RECORD DRAWING

Jeffery W. Darling
 JEFFERY W. DARLING
 Registered Land Surveyor
 No. 900017
 DATE: 5/29/03



This information was gathered for input into the Hamilton County Geographical Information System. This document is considered an official record of the GIS.
 Entry Date: 3-23-04
 Entered by: JDH

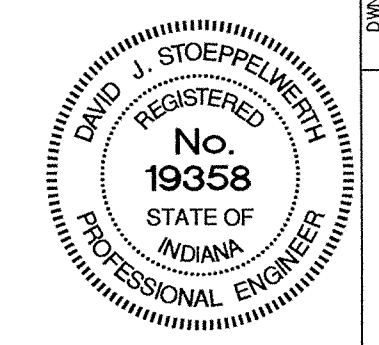

CERTIFIED: *David J. Stappeler*

DATE	MARK	REVISIONS
5/29/03		AS-BUILTS
10/29/02		REVISED PER HSE COMMENTS
7/19/02		REVISED PER COMMENTS
3/12/02		REV. PER TAC COMMENTS

CONSULTING ENGINEERS - LAND SURVEYORS
 (317) 849-5935 1-800-728-6917 FAX: (317) 849-5942
 INDIANAPOLIS INDIANA

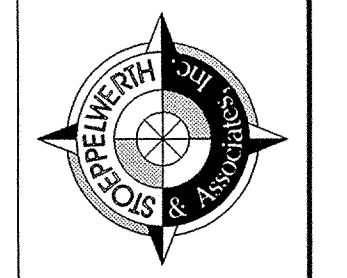

STORM SEWER PLAN & PROFILE

This copy is from the Digital Archive of the Hamilton County Surveyor's Office, Noblesville, In. 48060

3:4909051.dwg(51-5TM3.dwg, Layout1, 5/29/2003 11:22:22 AM, ktrapp, 1:1

This copy is from the Digital Archive of the Hamilton County Surveyor's Office, Noblesville, In 48060

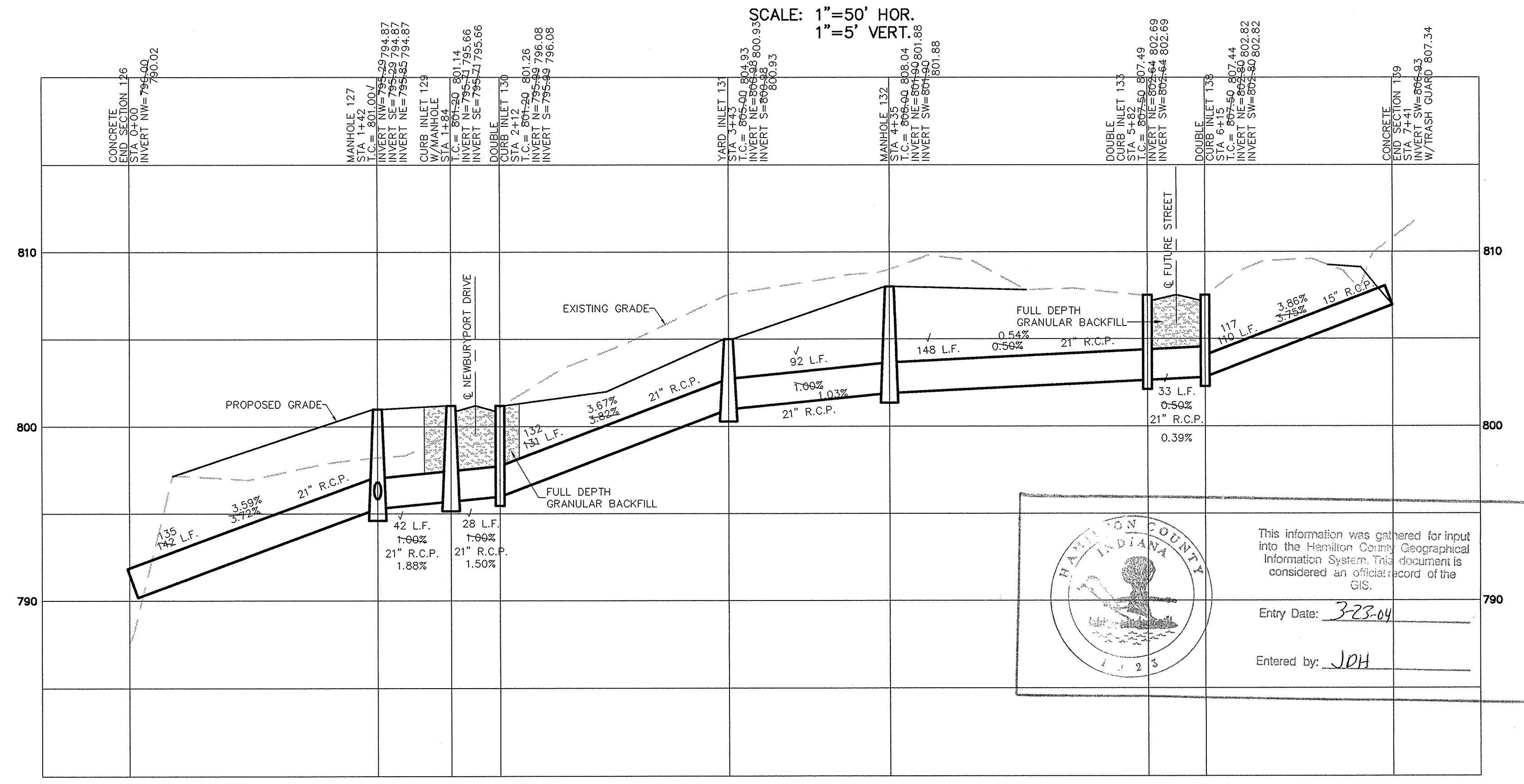
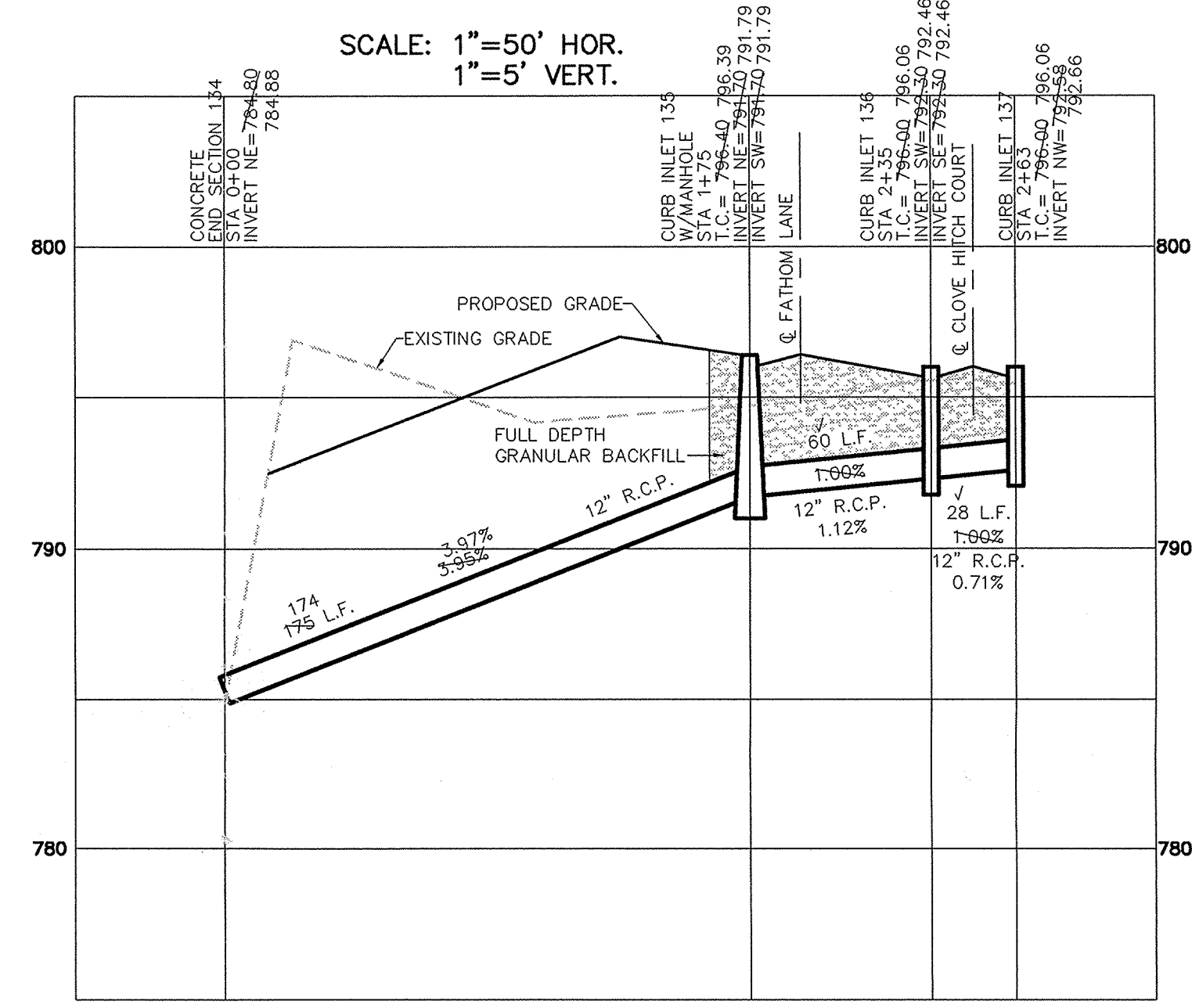
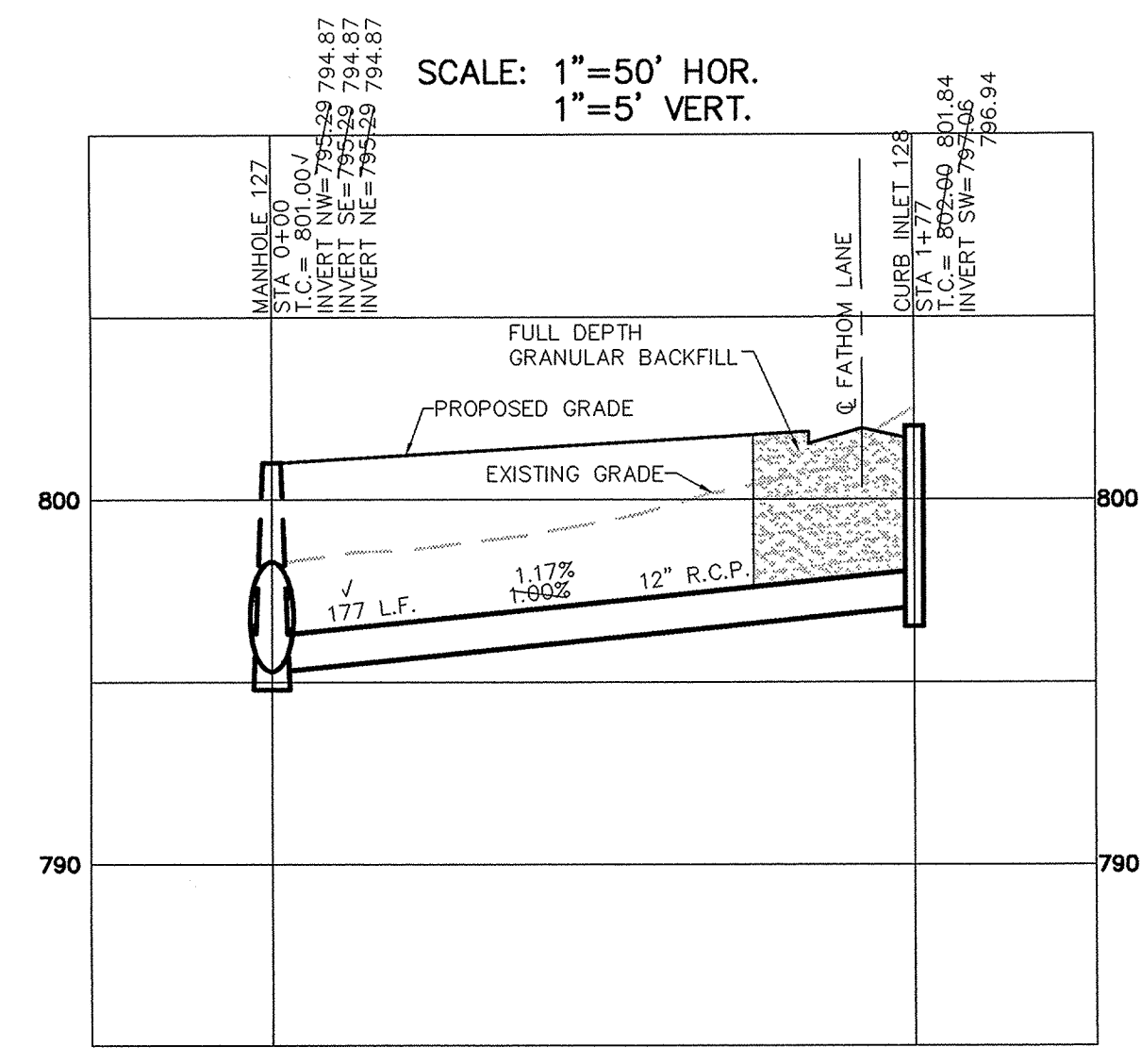

RECORD DRAWING

Jeffrey W. Darling
 Jeffrey W. Darling
 Registered Land Surveyor
 No. 900017
 DATE 5/29/03

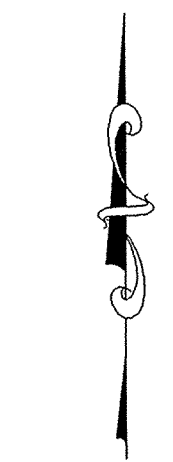
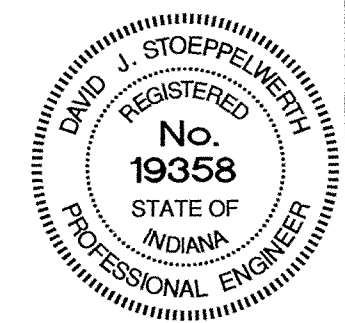

SCALE: 1" = 50'

INLET & MANHOLE STRUCTURE TABLE

PIPE	DEPTH	MINIMUM SIZE STRUCTURE	STEPS REQUIRED
15" or LESS	0-3'	2'x2' BOX	NO
15" or LESS	3'-4'	2'x3' BOX	YES
15" to 24"	3'-4'	3'x3' BOX	YES
ALL PIPES	4' & DEEPER	MANHOLE	YES
24"-GREATER	ALL DEPTHS	MANHOLE	YES

* Manholes to conform to ASTM 475

CERTIFIED: 1/24/02

CONSULTING ENGINEERS - LAND SURVEYORS
 (317) 849-5935 1-800-728-6917 FAX: (317) 849-5942
 INDIANAPOLIS INDIANA

David J. Stappewitz

STORM SEWER PLAN & PROFILE
 THE INTRACOASTAL AT GEIST
 SECTION 1

HAMILTON COUNTY INDIANA

REVISIONS

DATE	BY	REVISIONS
5/29/03	CRM	AS-BUILTS
7/7/02	EEF	REVISED PER HSE COMMENTS
6/7/02	EEF	REVISED PER COMMENTS
5/24/02	ONE	REVISED LOT LINES PER DEVELOPER
3/22/02	ONE	REV. FATHOM LANE
1/24/02	ONE	REV. PER ITC COMMENTS

SHEET NO. **30**
 OF 37 SHEETS
 JOB NO. 34090

Entry Date: 3-23-04
 Entered by: JPH

This information was gathered for input into the Hamilton County Geographical Information System. This document is considered an official record of the GIS.